

V192

NSYV1921-A2506

SEIKO WATCH CORPORATION

Copyright©2021 by SEIKO WATCH CORPORATION

Printed in China

D-15

SEIKO

V192

SOLAR CHRONOGRAPH INSTRUCTIONS

日本語 ..... **JA** 1

English ..... **EN** 1

そのほかの言語の取扱説明書は、パソコンやスマートフォンから当社ホームページ内の「カスタマーサービス」>「取扱説明書」にアクセスいただき、ご覧ください。

Please refer to the Instruction Manuals of other languages by accessing "Customer Service"→ "Instruction" on our Website from PC or Smartphone.

Deutsch / Français / Italiano / Español /

Русский язык / العربية / Português /

简体中文 / 繁體中文 / 한국어 / ไทย



<https://www.seikowatches.com/>

**Thank you very much for choosing a SEIKO watch.  
For proper and safe use of your SEIKO watch,  
please carefully read the instructions in this  
manual before use.**

- \* Length adjustment service for metallic bands is available at the retailer from whom the watch was purchased. If you cannot have your watch repaired by the retailer from whom the watch was purchased because you received the watch as a gift, or you moved to a distant place, please contact SEIKO CUSTOMER SERVICE CENTER. The service may also be available on a chargeable basis at other retailers, however, some retailers may not undertake the service.
- \* If your watch has a protective film for preventing scratches, make sure to peel it off before using the watch. If the watch is used with the film on it, dirt, sweat, dust, or moisture may be attached to the film and may cause rust.

EN 1

## CONTENTS

### 1 HOW TO USE

Handling cautions .....	4
Characteristics .....	8
Names of the parts and their functions .....	9
Crown .....	10
Button (only for models with the screw lock type button) .....	11
Toggling between displays .....	12

### 2 HOW TO SET THE TIME AND DATE

How to set the time and date .....	13
How to set the time and date .....	13
Manual date adjustment at the end of the month .....	16

### 3 HOW TO USE THE STOPWATCH

Stopwatch function .....	17
The names of the parts and functions of the stopwatch .....	17
Before using the stopwatch .....	18
How to use the stopwatch .....	20
How to use the tachymeter .....	24

### 4 SOLAR CHARGING FUNCTION

Charging the battery .....	26
How to charge the battery .....	26
Guide to charging times .....	27
About energy .....	28
How to display the energy level .....	28

### 5 TO PRESERVE THE QUALITY OF YOUR WATCH

Power Source .....	29
Daily care .....	31
Performance and type .....	32
Lumibrite .....	33
Water resistant performance .....	34
Magnetic resistant performance .....	35
Band .....	37
How to use tri-fold type clasp for leather band (Special clasps) .....	40
How to use an easy adjust type clasp .....	46
After sales service .....	49

### 6 TROUBLESHOOTING

Setting the stopwatch hands (1/5-second and minute hands) to the preliminary position .....	51
Troubleshooting .....	55
If the hands fail to move or move abnormally even after recharging .....	58
Resetting the built-in IC .....	58

### 7 SPECIFICATIONS

Specifications .....	60
----------------------	----

EN 2

EN 3

## Handling cautions

### ⚠ WARNING

Please note that there is a risk of serious consequences such as severe injury if the following safety regulations are not strictly observed.

#### Immediately stop wearing the watch in following cases:

- If the watch body or band becomes edged by corrosion etc.
- If the pins protrude from the band.
- \* Immediately consult the retailer from whom the watch was purchased or SEIKO CUSTOMER SERVICE CENTER.

#### Keep the watch and accessories out of the reach of babies and children.

Care should be taken to prevent a baby or a child accidentally swallowing the accessories. If a baby or child swallows the battery or accessories, immediately consult a doctor, as it will be harmful to the health of the baby or child.

#### Do not remove the secondary battery from the watch.

- \* About the secondary battery → Power Source → P.29
- Replacement of the secondary battery requires professional knowledge and skill. Please ask the retailer from whom the watch was purchased for replacement of the secondary battery.
- Installation of an ordinary silver oxide battery can generate heat that can cause bursting and ignition.

### ⚠ CAUTION

Please note that there is a risk of minor injury or material damage if the following safety regulations are not strictly observed.

#### Avoid the following places for wearing or keeping the watch:

- Places where volatile agents (cosmetics such as polish remover, bug repellent, thinners etc.) are vaporizing
- Places where the temperature drops below 5°C or rises above 35°C for a long time
- Places affected by strong magnetism or static electricity
- Places affected by strong vibrations
- Places of high humidity
- Dusty places

#### If you observe any allergic symptoms or skin irritation

Stop wearing the watch immediately and consult a specialist such as a dermatologist or an allergist.

#### Other cautions

- For adjusting the length of the metallic band, specialized knowledge and expertise are necessary. Therefore, in such a case, contact the retailer from whom the watch was purchased. If you attempt to adjust the metallic band, injury may occur to your hand or fingers, or parts of the band may be lost.
- Do not disassemble or tamper with the watch.
- Keep the watch out of the reach of babies and children. Extra care should be taken to avoid risks of any injury or allergic rash or itching that may be caused when you touch the watch.
- If your watch is of the fob or pendant type, the strap or chain attached to the watch may damage your clothes, or injure the hand, neck, or other parts of your body.

### ⚠ WARNING



#### Do not use the watch in scuba diving or saturation diving.

The various tightened inspections under simulated harsh environment, which are usually required for watches designed for scuba diving or saturation diving, have not been conducted on the water resistant watch with the BAR (barometric pressure) display. For diving, use watches specifically designed for diving.

### ⚠ CAUTION



#### Do not pour running water directly from faucet.

The water pressure of tap water from a faucet is high enough to degrade the water resistant performance of a water resistant watch for everyday life.

### ⚠ CAUTION

Please note that there is a risk of minor injury or material damage if the following safety regulations are not strictly observed.



#### Do not turn or pull out the crown when the watch is wet.

Water may get inside of the watch.

- \* If the inner surface of the glass is clouded with condensation or water droplets appear inside of the watch for a long time, the water resistant performance of the watch is deteriorated. Immediately consult the retailer from whom the watch was purchased or SEIKO CUSTOMER SERVICE CENTER.



#### Do not leave moisture, sweat and dirt on the watch for a long time.

Be aware of a risk that a water resistant watch may lessen its water resistant performance because of deterioration of the adhesive on the glass or gasket, or the development of rust on stainless steel.



#### Do not wear the watch while taking a bath or a sauna.

Steam, soap or some components of a hot spring may accelerate the deterioration of water resistant performance of the watch.

## Characteristics

This solar watch is equipped with a stopwatch function.

- A full-scale stopwatch, which can measure in 1/5-second increments with the center hand, is equipped.
- A solar cell under the dial converts any form of light into "electrical energy" to operate the watch.

\* "Chronograph" means a watch with a stopwatch function.

■ **Stopwatch function**..... The stopwatch can measure up to 60 minutes in 1/5-second increments. After measuring 60 minutes, the stopwatch will automatically stop.  
→ P.17

■ **Solar Charging Function**..... The watch charges by converting light that shines on the solar panel on the dial into electrical energy. After the battery is fully charged, the watch will operate for about six months even if the dial is not exposed to light.  
→ P.26

■ **Energy level display function**.. The energy level is displayed on the "charge level display".  
→ P.28

## Names of the parts and their functions

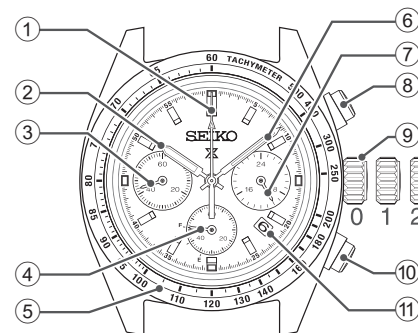

① **Stopwatch 1/5-second hand (center hand)**

② **Hour hand**

③ **Small seconds hand**

④ **Stopwatch minute hand (energy level hand)**

⑤ **Tachymeter**

⑥ **Minute hand**

⑦ **24-hour hand**

⑧ **Button A**  
Toggling to the stopwatch display

⑨ **Crown**

- Normal position (not locked): Stopwatch and charging functions
- First click position: Date setting
- Second click position: Setting the time, setting the stopwatch hands to preliminary position, and performing a system reset

⑩ **Button B**  
Toggling to the charge level display

⑪ **Date**

\* The position and design of the display may vary depending on the model.

## Crown

There are two types of crowns, a normal crown and a screw down crown. Please check the type of the crown of your watch.

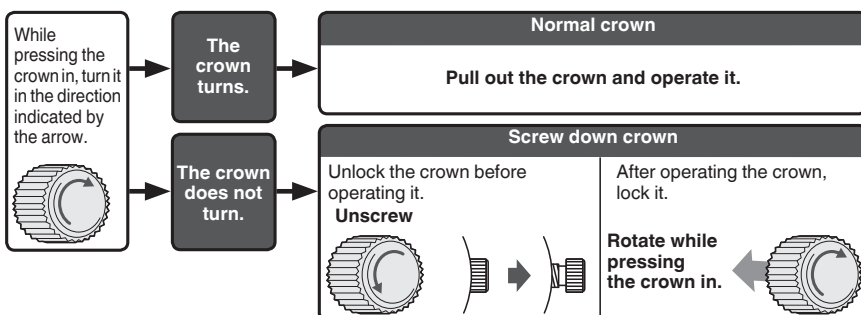

- \* By locking the crown by screw, a screw down crown can prevent malfunction and increase water resistance.
- \* Be careful not to screw the crown in by force as it may damage the slots of the crown.

## Button (only for models with the screw lock type button)

The screw lock type button features a mechanism that can securely lock the button when it is not being operated in order to prevent any operational errors.

- It is necessary to unlock the screw lock type button before operating it.
- Once you have finished operating the button, make sure to relock it.

### 【To unlock the button】

- Turn the button ring counterclockwise until it stops.
- Now the button can be operated.

### 【To lock the button】

- Turn the button ring clockwise until it stops.
- Now the button can no longer be operated.

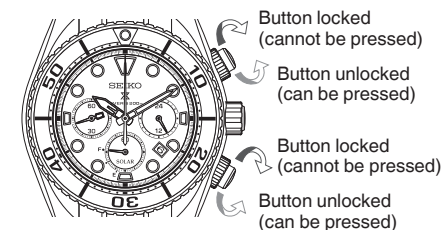

\* If the screw or button get dirty, they may not operate properly. "Daily care" → P.31

\* Note that if you turn the button ring more than you need to, the screw lock button may be difficult to return to its original position.

\* Do not use the buttons when the watch is wet or when you are underwater.

## Toggling between displays

The operation shown in the illustration below toggles between “charge level display” and “stopwatch display”.

Toggling between the displays changes the function of the hands.

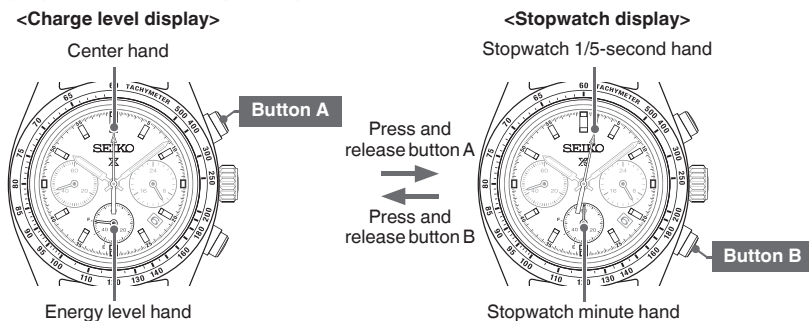

- \* On the “charge level display”, press button A to toggle to the “stopwatch display” and simultaneously start the stopwatch.
- \* While the stopwatch is operating, you cannot toggle the display. To return to the “charge level display”, first reset the stopwatch.
- During operation of the stopwatch, button B provides “split”, “split reset” and “reset” functions.
- On resetting the stopwatch, the display automatically returns to “charge level display” after 1 minute.

EN 12

### 3 Pull out the crown to the first click.

The small seconds hand will continue to move.

- \* For models with screw down crown, please unlock the crown before operating it.

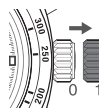

Pull out the crown to the first click

### 4 The date can be set by turning the crown.

Turn it until the previous day's date appears.  
Ex.) To display the date as “6”, then set this to “5”.  
Turn the crown clockwise to set the date.

EN 14

## How to set the time and date

### How to set the time and date

\* When setting the date only, refer to “Manual date adjustment at the end of the month” → P.16.

#### 1 Make sure that the watch is working.

Check that the small seconds hand is moving every second.

If it is moving every two seconds or has stopped, expose the dial to light to charge the watch. “Charging the battery” → P.26

#### 2 Check that the watch hands are not displaying any time between 9 p.m. and 1 a.m.

If a time between 9 p.m. and 1 a.m. is being displayed, pull the crown to the second click, advance the hands beyond the 1 a.m. position, and push the crown back in.

\* This procedure is required to ensure the proper engagement of the date driving wheel.

\* Each time the hour hand makes two full rotations, the date is adjusted by “one day”. While turning the crown, the moment the date changes is midnight. Use the 24-hour hand to check whether the displayed time is a.m./p.m. “Names of the parts and their functions” → P.9

#### 5 Pull out the crown to the second click and set the time.

Pull out when the small seconds hand has reached the 0 seconds position. (The small seconds hand will stop moving.)

Turn the crown to advance the hands until the date changes to the following date. The time is now set for the A.M. period. Advance the hands to set the correct time.

\* Use the 24-hour hand to check whether the displayed time is a.m./p.m.

\* In order to set the time accurately, turn the minute hand 4 to 5 minutes ahead and then return it to the correct time.

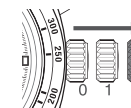

#### 6 Push the crown back in to the normal position in accordance with a time signal.

The small seconds hand will start moving.

\* The telephone time signal service is helpful for setting the small seconds hand exactly.

\* For models with screw down crown, please be sure to lock the crown after operating it.

EN 13

EN 15

## Manual date adjustment at the end of the month

It is necessary to adjust the date at the end of February and 30-day months.

Ex.) To adjust the date in the A.M. period on the first day of a month following a 30-day month  
The watch displays "31" instead of "1". Pull out the crown to the first click.

Turn the crown clockwise to set the date to "1" and then push the crown back in to the normal position.

\* For models with screw down crown, please be sure to lock the crown after operating it.

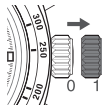

Pull out the crown to the first click

### CAUTION

- Avoid amending the date when the watch is displaying between 9 PM and 1 AM. Doing so may cause damage.

## Stopwatch function

The stopwatch can measure up to 60 minutes in 1/5-second increments. After measuring 60 minutes, the stopwatch hands will automatically stop at the 0 minute 0 second position.

### The names of the parts and functions of the stopwatch

Toggle to the "stopwatch display". "Toggling between displays" → P.12

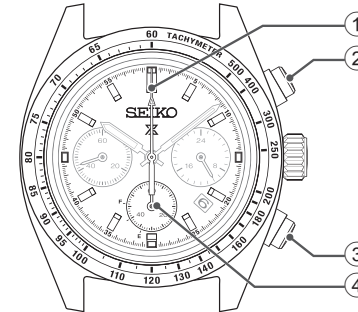

① Center hand ⇒ stopwatch  
1/5-second hand  
moves in 1/5-second increments

② Button A  
Start/Stop

③ Button B  
Split/Reset

④ Energy level hand ⇒ stopwatch  
minute hand  
moves in one-minute increments

## Before using the stopwatch

The stopwatch on this watch can be started directly from the "charge level display".

On the stopwatch display, use the following operation to reset the stopwatch if it has not been reset. Do not use this operation otherwise.

Before using the stopwatch, reset it and check that the stopwatch hands (1/5-second hand, minute hand) are stopped at "0 seconds and 0 minutes". For how to reset the stopwatch, see the illustration below.

\* The stopwatch will not operate when the small seconds hand is moving every 2 seconds.

"About energy" → P.28

### How to reset the stopwatch

\* The stopwatch can be operated when the crown is at the normal position.

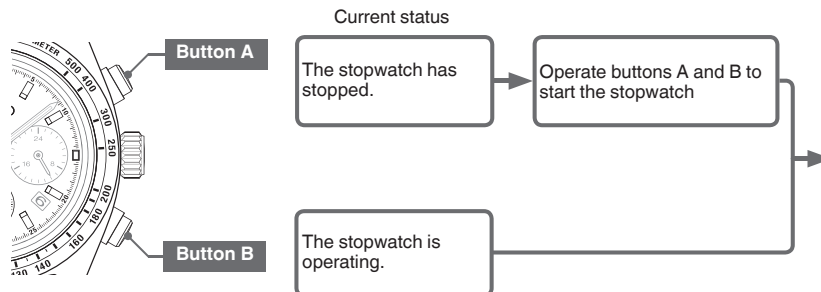

If any of the stopwatch hands do not return to 0 minute 0 second when the stopwatch is reset, set the stopwatch hands to the preliminary hand position.

→ "Setting the stopwatch hands (1/5-second and minute hands) to the preliminary position" P. 51

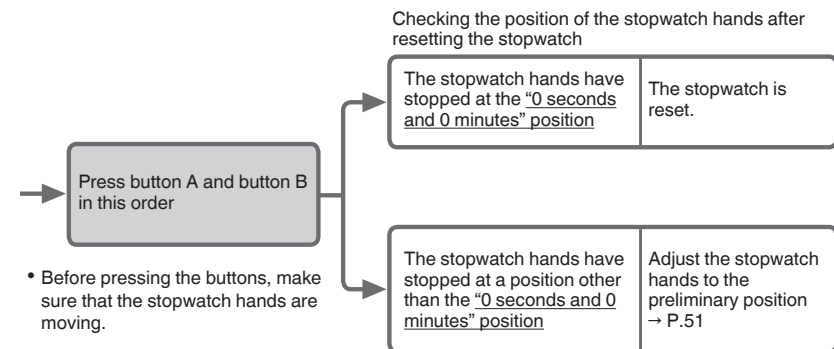

## How to use the stopwatch

\* The stopwatch will not operate when the small seconds hand is moving every 2 seconds.  
 "About energy" → P.28

### • Standard measurement Ex. 5,000 meters running

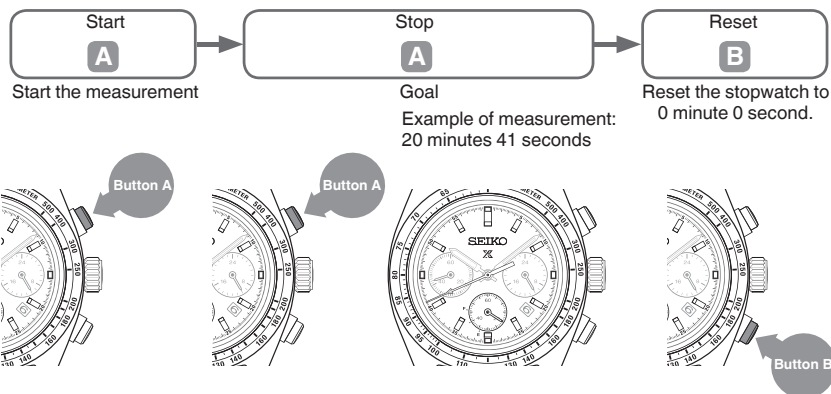

EN 20

3 HOW TO USE THE STOPWATCH

### • Accumulated elapsed time measurement Ex. Measuring the time for a soccer match

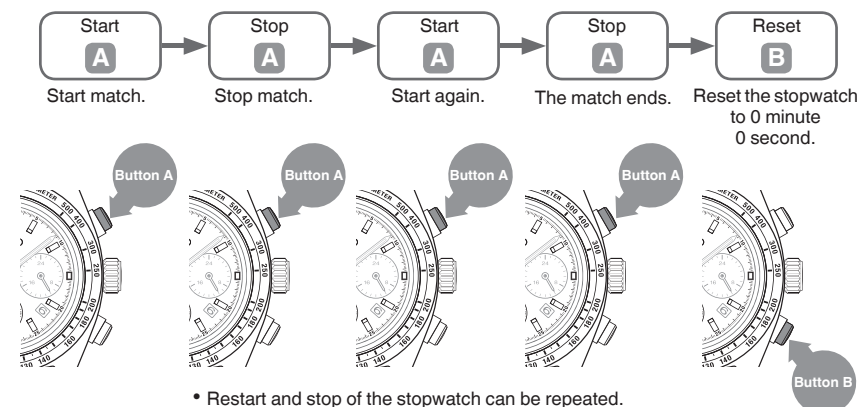

EN 21

3 HOW TO USE THE STOPWATCH

### • Split time (intermediate elapsed time) measurement Ex. 5,000 meters running

\* "Split time" is the time that has elapsed from the start of an activity to any given stage.

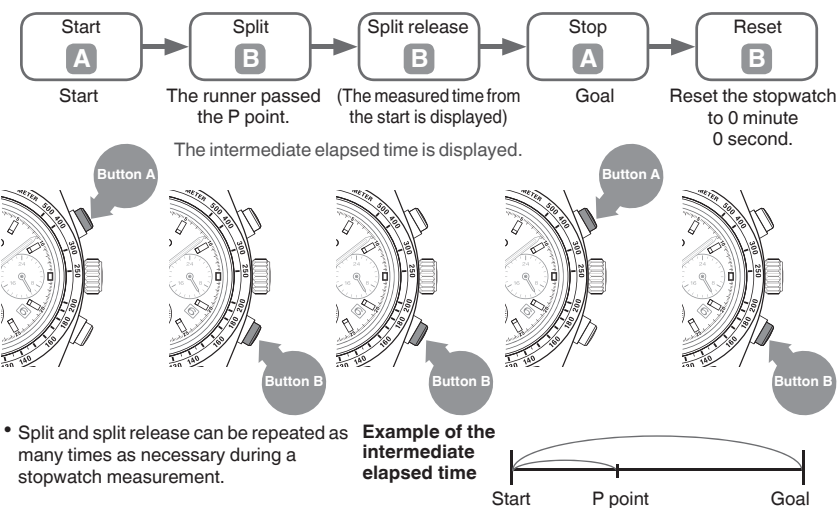

EN 22

3 HOW TO USE THE STOPWATCH

### • Measurement of two competitors

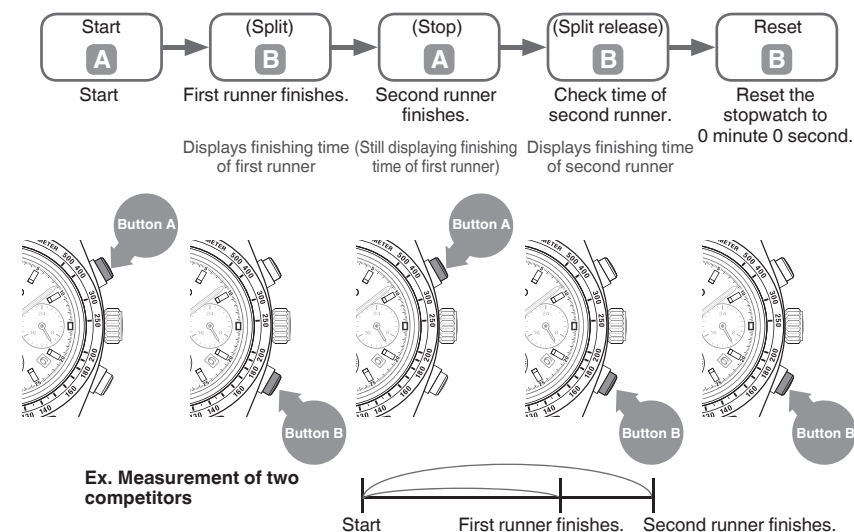

EN 23

3 HOW TO USE THE STOPWATCH



## How to use the tachymeter

The numbers on the tachymeter scale can be read to determine how many seconds it takes to run 1 km or to measure the time required to complete 1 job.

- How to measure kilometers / hour

**1** Measure the time (within 1 minute) it takes to run 1 km.

**2** Read the number on the tachymeter scale that the stopwatch 1/5-second hand is pointing to.

Ex. : If it takes 45 seconds to run 1 km...80 km/h

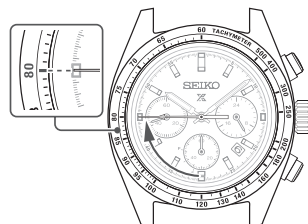

- How to measure the hourly rate of operation

**1** Measure the time (within 1 minute) required to complete 1 job.

**2** Read the number on the tachymeter scale that the stopwatch 1/5-second hand is pointing to.

Ex. : If it takes 20 seconds to complete one product...180 products/hour

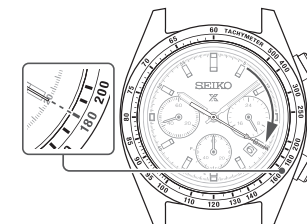

EN 24

EN 25

## Charging the battery

### How to charge the battery

Expose the dial to light to charge the watch.

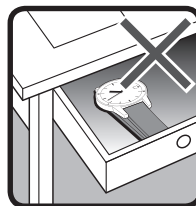
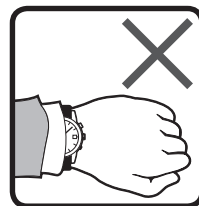

To ensure optimal performance of the watch, make sure that the watch is kept sufficiently charged at all times.

Under the following situations, the energy of the watch is likely to be depleted, resulting in stoppage of the watch:

- The watch is concealed under a sleeve.
- The watch is used or stored under conditions where it cannot be exposed to light for a long time.

\* Be careful to make sure that the watch does not get hot when it is charging. (The operating temperature range is between  $-10^{\circ}\text{C}$  and  $+60^{\circ}\text{C}$  ( $14^{\circ}\text{F}$  and  $140^{\circ}\text{F}$ ).)

\* When you first start using the watch or starting it after it stopped due to a lack of charge, charge the watch sufficiently using the table on P.27 as a guide.

EN 26

### Guide to charging times

Charge the watch using the times below as a guide.

Illuminance lx (LUX)	Light source	Condition (Example)	Time required for fully charging the watch	Time required for charging the watch to start moving at one-second intervals	Time required for charging the watch to last for 1 day
700	Fluorescent light	General offices	-	60 hours	2.5 hours
3,000	Fluorescent light	30 W 20 cm	110 hours	13 hours	33 minutes
10,000	Fluorescent light	30 W 5 cm	30 hours	3.5 hours	9 minutes
10,000	Sunlight	Cloudy day	30 hours	3.5 hours	9 minutes
100,000	Sunlight	Sunny day (Under direct sunlight on a summer day)	5 hours	36 minutes	2 minutes

The figures of "Time required for charging the watch to start moving at one-second intervals" are estimations of time required to charge the stopped watch by exposing it to light until it moves at steady one-second intervals. Even if the watch is partially charged for a shorter period, the watch will resume one-second interval movement. However, it may shortly return to two-second interval movement. Use the charging time in this column as a rough guide for sufficient charging time.

\* The required charging time slightly varies depending on the model of the watch.



EN 27



## About energy

### How to display the energy level

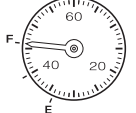
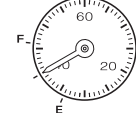
On the "charge level display", the energy level hand indicates the energy level. "Toggling between displays" → P.12

Display			
Energy level	Full	Approximately half-full	Low
Approximate length of continuous operation	At least 100 days	2 days to 100 days	Less than 2 days
Solutions	Continue to use in current state	Use while paying attention to recharging	The small seconds hand will start "2-second movement" in which it moves every 2 seconds. Please charge until fully charged. * If the stopwatch is used, it will automatically reset and the display will change to the "charge level display".

\* Please be aware that immediately after charging, the energy level display may show a level one higher than the actual level.

EN 28

### \* Overcharge prevention function

When the secondary battery is fully charged, the overcharge prevention function is automatically activated to avoid further charging.

There is no need to worry about damage caused by overcharging no matter how much the secondary battery is charged in excess of the "time required for fully charging the watch".

\* For the required time to fully charge the battery, see "Guide to charging times" → P.27.

### WARNING

#### Notes on charging the watch

- When charging the watch, do not place the watch in close proximity to an intense light source such as lighting equipment for photography, spotlights or incandescent lights, as the watch may be excessively heated resulting in damage to its internal parts.
- When charging the watch by exposure to direct sunlight, avoid places that easily reach high temperatures, such as a car dashboard.
- Always keep the watch temperature under 60°C.

EN 30

## Power Source

The battery used in this watch is a special secondary battery, which is different from ordinary batteries.

Unlike an ordinary silver oxide battery, the secondary battery does not require periodic replacement.

The capacity or charging efficiency may gradually lower due to long-term use or operating environment.

In addition, long-term use may shorten the charge duration due to wear, contamination, lubricant deterioration of mechanical parts, etc. Request repair when the performance lowers.

### WARNING

#### Notes on replacing the secondary battery

- Do not remove the secondary battery from the watch. Replacement of the secondary battery requires professional knowledge and skill. Please ask the retailer from whom the watch was purchased for replacement of the secondary battery.
- Installation of an ordinary silver oxide battery can generate heat that can cause bursting and ignition.

EN 29

## Daily care

### The watch requires good daily care

- Do not wash the watch when its crown is in the extended position.
- Wipe away moisture, sweat or dirt with a soft cloth.
- After soaking the watch in seawater, be sure to wash the watch in clean pure water and wipe it dry carefully.

Do not pour running water directly from a faucet onto the watch. Put some water into a bowl first, and then soak the watch in the water to wash it.

\* If your watch is rated as "Non-water resistant" or "water resistant for daily use", please do not wash the watch. "Performance and type" → P.32

"Water resistant performance" → P.34

### Turn the crown from time to time

- In order to prevent corrosion of the crown, turn the crown from time to time.
- The same practice should be applied to a screw down crown. "Crown" → P.10

### Press the button once in a while

- Press the button once in a while to prevent corrosion of the button.
- The same applies to the screw-locked buttons. "Button (only for models with the screw lock type button)" → P.11

EN 31

## Performance and type

The case back shows the caliber and performance of your watch

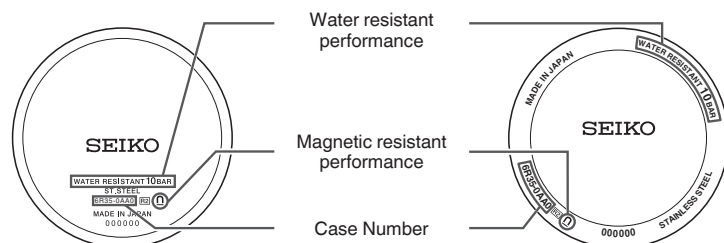

• **Water resistant performance**

Please refer to P.34.

• **Case Number**

The number to identify the type of your watch.

• **Magnetic resistant performance**

Please refer to P.35 and P.36.

\* The above illustration is provided as an example, therefore it may not be exactly the same as your watch.

## Lumibrite

**If your watch has Lumibrite**

Lumibrite is a luminous paint that absorbs the light energy of sunlight and lighting apparatuses in a short time and stores it to emit light in the dark. For example, if exposed to a light of more than 500 lux for approximately 10 minutes, Lumibrite can emit light for 3 to 5 hours. Please note, however, that, as Lumibrite emits the light it stores, the luminance level of the light decreases gradually over time. The duration of the emitted light may also differ slightly depending on such factors as the brightness of the place where the watch is exposed to light and the distance from the light source to the watch.

\* In general, when coming from a place that is bright to a place that is dark, it takes human eyes some time to adapt to the darkness making it difficult to see objects initially. (Dark adaptation)

\* Lumibrite is luminous paint that stores and emits light, which is harmless to human beings and the environment, containing no toxic materials such as radioactive substances.

**<Brightness levels>**

Condition	Illumination	
Sunlight	Fine weather	100,000 lux
	Cloudy weather	10,000 lux
Indoor (Window-side during daytime)	Fine weather	More than 3,000 lux
	Cloudy weather	1,000 to 3,000 lux
	Rainy weather	Less than 1,000 lux
Lighting apparatus (40-watt daylight fluorescent light)	Distance to the watch: 1 m	1,000 lux
	Distance to the watch: 3 m	500 lux (Average room luminance)
	Distance to the watch: 4 m	250 lux

## Water resistant performance

Refer the table below for the description of water resistant performance of your watch before using. (Please look at P.32.)

Indication on the case back	Water resistant performance	Conditions of Use
No indication	Non-water resistance	Avoid drops of water or sweat
WATER RESISTANT	Water resistance for everyday life	The watch withstands accidental contact with water in everyday life. <b>⚠ WARNING</b> Please do not use it for swimming.
WATER RESISTANT 5 BAR	Water resistance for everyday life at 5-BAR water resistant	The watch is suitable for sports such as swimming.
WATER RESISTANT 10 (20) BAR	Water resistance for everyday life at 10 (20)-BAR water resistant	The watch is suitable for diving not using an air cylinder.

## Magnetic resistant performance

**Affected by nearby magnetism,  
a watch may temporarily gain or lose time or stop operating.**

⚠ DANGER	
Indication on the case back	Condition of use
No indication	Keep the watch more than 10 cm away from magnetic products.
U	Keep the watch more than 5 cm away from magnetic products. (JIS level-1 standard)
U	Keep the watch more than 1 cm away from magnetic products. (JIS level-2 standard)

If the watch becomes magnetized and its accuracy deteriorates to an extent exceeding the specified rate under normal use, the watch needs to be demagnetized. In this case, you will be charged for demagnetization and accuracy readjustment even if it happens within the guarantee period.

**The reason why a watch is affected by magnetism**

The built-in motor is provided with a magnet, which may be influenced by a strong external magnetic field.

## Examples of common magnetic products that may affect watches



Smartphone, cellular phone, tablet terminal  
(Speaker, magnet of cover)



AC adapter



Bag  
(With magnet buckle)



AC-powered shaver



Magnetic cooking device



Portable radio  
(Speaker)



Magnetic necklace

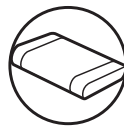

Magnetic health pillow

### ● Leather band

- A leather band is susceptible to discoloration and deterioration from moisture, sweat and direct sunlight.
- Wipe off moisture and sweat as soon as possible by gently blotting them up with a dry cloth.
- Do not expose the watch to direct sunlight for a long time.
- Please take care when wearing a watch with light-colored band, as dirt is likely to show up.
- Refrain from wearing a leather band watch other than Aqua Free bands while bathing, swimming, and when working with water even if the watch itself is water resistant enforced for daily use (10-BAR/20-BAR water resistant).

### ● Fabric band (Nylon/Polyester)

- Natural skin oil and dirt easily adhere to the band because it has a braided structure.
- Beware of fraying, damage, etc., caused by catching this product on other things.
- Note that the band may become discolored due to friction when wet with sweat or rain and that its color may transfer to other clothing.
- Beware of static electricity caused by friction with clothing material.
- If natural skin oil or dirt adheres to the band, gently wipe it off immediately with a dry cloth, etc.
- When drying the band, dry it in an airy place out of direct sunlight.
- The texture of the band may change if it is washed in water for a long time.
- Note that the band may discolor if it is left in direct sunlight.

## Band

The band touches the skin directly and becomes dirty with sweat or dust. Therefore, lack of care may accelerate deterioration of the band or cause skin irritation or stain on the sleeve edge. The watch requires a lot of attention for long usage.

### ● Metallic band

- Moisture, sweat or soil will cause rust even on a stainless steel band if they are left for a long time.
- Lack of care may result in a rash or cause a yellowish or gold stain on the lower sleeve edge of shirts.
- Wipe off moisture, sweat or soil with a soft cloth as soon as possible.
- To clean the soil around the joint gaps of the band, wipe it out in water and then brush it off with a soft toothbrush.  
(Protect the watch body from water splashes by wrapping it up in plastic wrap etc.)  
Clean it off with a soft cloth.
- Because some titan bands use pins made of stainless steel, which has outstanding strength, rust may form in the stainless steel parts.
- If rust advances, pins may poke out or drop out, and the watch case may fall off the band, or the clasp may not open.
- If a pin is poking out, personal injury may result. In such a case, refrain from using the watch and request repair.

### ● Silicone band

- As for material characteristics, the band is easily dirtied, and may be stained and discolored. Wipe off dirt with a wet cloth or cleaning tissue.
- Unlike bands of other materials, cracks may result in the band being cut. Take care not to damage the band with an edged tool.

Notes on skin irritation and allergy	Skin irritation caused by a band may result from various factors such as allergy to metals or leathers, or skin reactions against friction on dust or the band itself.
Notes on the length of the band	Adjust the band to allow a little clearance with your wrist to ensure proper airflow. When wearing the watch, leave enough room to insert a finger between the band and your wrist.



## How to use tri-fold type clasp for leather band (Special clasps)

There are 3 types of special clasps as described below;  
If the clasp of the watch you purchased is one of them, please refer to the indications.

### A A Type → P.41

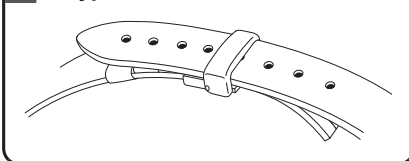

### B B Type → P.42

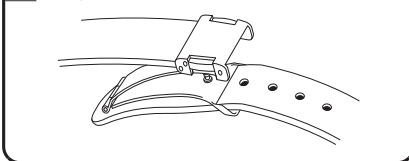

### C C Type → P.43

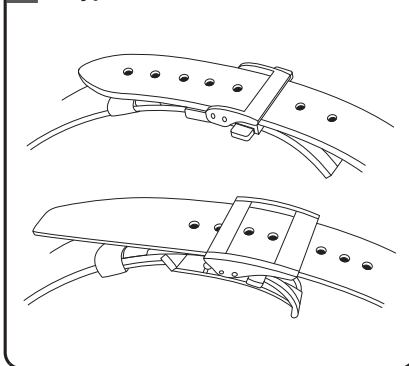

5

TO PRESERVE THE QUALITY OF YOUR WATCH

EN 40

### B B Type

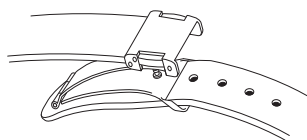

① While pressing the push buttons on both sides of the flap, lift to open the clasp.

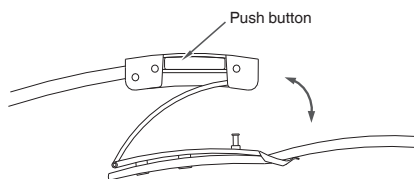

② Remove the pin from the adjustment hole. Slide the band left and right, and insert the pin into the adjustment hole at an appropriate length. Push the buckle and fasten the clasp.

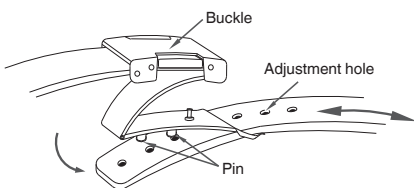

5

TO PRESERVE THE QUALITY OF YOUR WATCH

EN 42

### A A Type

① Lift up the clasp to release the buckle.

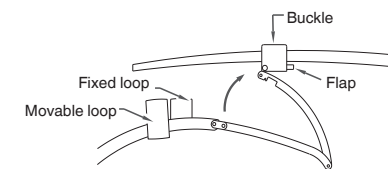

② Open the flap.

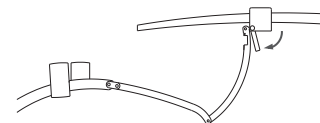

③ Remove the pin from the adjustment hole. Slide the band left and right, and reinsert the pin into the adjustment hole at an appropriate length.

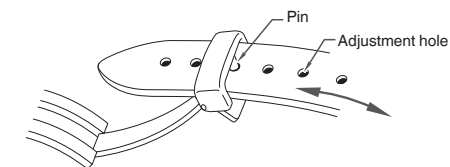

④ Fasten the flap.

\* Do not push the flap in too hard.

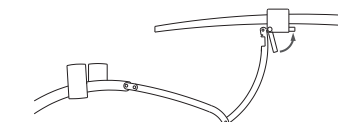

\* When fastening the clasp, insert the tip of the band into the movable loop and fixed loop, and then, securely tighten the clasp.

5

TO PRESERVE THE QUALITY OF YOUR WATCH

EN 41

### C C Type

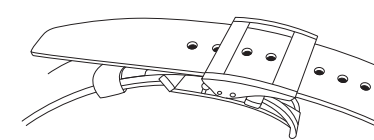
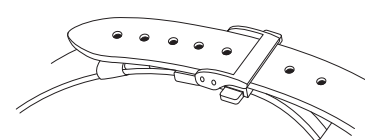

### ● How to wear or take off the watch

① While pressing the push buttons on both sides of the flap, pull the band out of the movable loop and fixed loop. Then open the clasp.

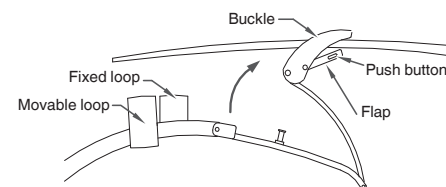

② Place the tip of the band into the movable loop and fixed loop, and fasten the clasp by pressing the frame of the buckle.

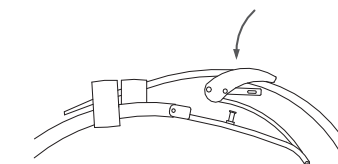

5

TO PRESERVE THE QUALITY OF YOUR WATCH

EN 43

## ● How to adjust the length of the band

- ① While pressing the push buttons on both sides of the flap, pull the band out of the movable loop and fixed loop. Then open the clasp.

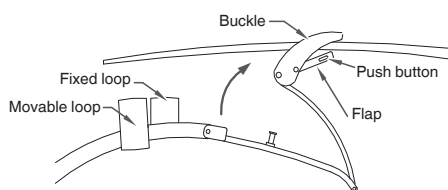

- ② Press the push buttons again to unfasten the flap.

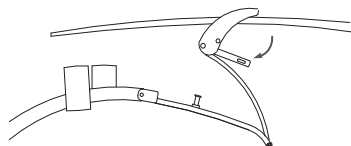

- ③ Pull the pin out of an adjustment hole of the band. Slide the band to adjust its length and find an appropriate hole. Place the pin into the hole.

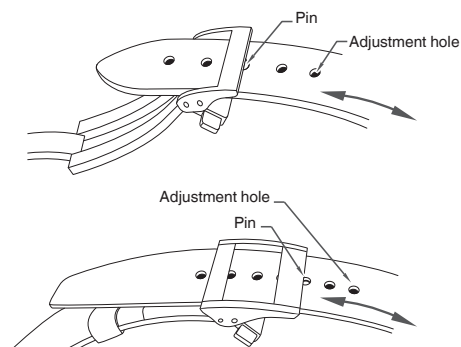

- ④ Fasten the flap.

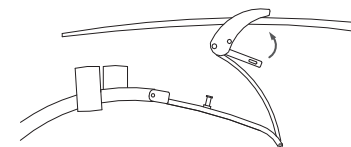

## How to use an easy adjust type clasp

Some bands are provided with an easy adjust type clasp for fine adjustment of the band's length. If the clasp of the watch you purchased is of this type, please refer to the following instructions.

\* The band can be lengthened by up to about 5 mm.

This is useful if the band feels too tight or is uncomfortable for some reason.

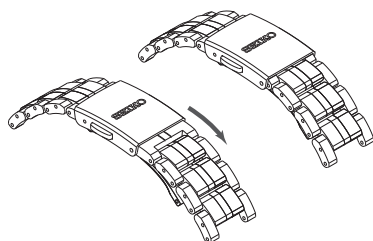

## ● How to wear the band (Opening and closing the clasp)

1. Lightly press the push buttons to open the clasp.

\* Note that pressing the push buttons too firmly (deeply) actuates the adjuster, which lengthens the band.

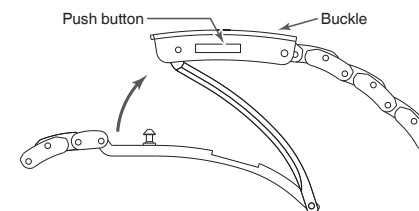

2. Fasten the clasp by pressing the frame of the buckle.

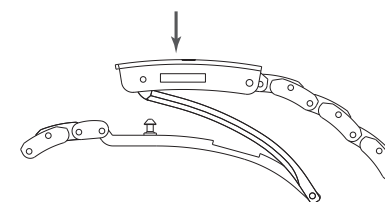

### ● How to adjust the length of the band

1. You can lengthen the band by up to about 5 mm (2 stages) by firmly pressing the push buttons from both sides to actuate the adjuster.
2. Fasten the clasp by pressing the frame of the buckle.

\* Even while the clasp is closed, you can still retract the length of band extended by the adjuster.

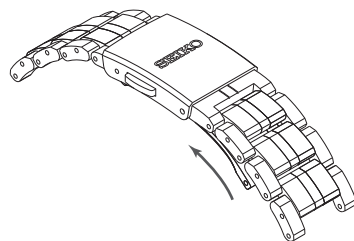
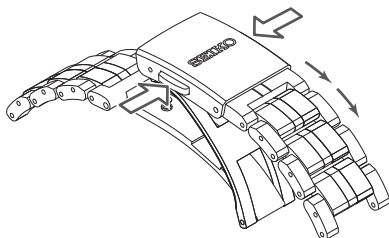

\* The above illustrations are provided as examples. Some details may differ depending on the model.

### ● Inspection and adjustment by disassembly and cleaning (Overhaul)

- Periodic inspection and adjustment by disassembly and cleaning (overhaul) is recommended approximately once every 3 to 4 years in order to maintain optimal performance of the watch for a long time. According to use conditions, the oil retaining condition of your watch mechanical parts may deteriorate, abrasion of the parts may occur due to contamination of oil, which may ultimately lead the watch itself to stop. As the parts such as gasket may deteriorate, water-resistant performance may be impaired due to intrusion of perspiration and moisture. Please contact the retailer from whom the watch was purchased for inspection and adjustment by disassembly and cleaning (overhaul). For replacement of parts, please specify "SEIKO GENUINE PARTS". When asking for inspection and adjustment by disassembly and cleaning (overhaul), make sure that the gasket and push pin are also replaced with new ones.
- When your watch is inspected and adjusted by disassembly and cleaning (overhauled), the movement of your watch may be replaced.

## After sales service

### ● Notes on guarantee and repair

- Contact the retailer from whom the watch was purchased or SEIKO CUSTOMER SERVICE CENTER for repair or overhaul.
- Within the guarantee period, present the certificate of guarantee to receive repair services.
- Guarantee coverage is provided in the certificate of guarantee. Read carefully and retain it.
- For repair services after the guarantee period has expired, if the functions of the watch can be restored by repair work, we will undertake repair services upon request and payment.

### ● Replacement with functional parts

- Please keep in mind that if original parts are not available, they may be replaced with substitutes whose outward appearance may differ from the originals.

## Setting the stopwatch hands (1/5-second and minute hands) to the preliminary position

If any of the stopwatch hands do not return to the 0 minute 0 second position when the stopwatch is reset, the preliminary hand position may be misaligned.

Adjusting the hands to the preliminary position will ensure that stopwatch measurements are correct.

The preliminary position may be misaligned due to the following reasons.

- In the case of a strong impact: Misalignment may occur when dropping or hitting the watch.
- In the case of a magnetic influence: Misalignment may occur when bringing the watch close to an object which generates magnetism.

"Examples of common magnetic products that may affect watches" → P.36

\* If the preliminary position adjustment is carried out, the watch gains or loses time. After adjusting the preliminary hand position, make sure to reset the main time.

# 1 Make sure that the watch is working.

Check that the small seconds hand is moving every second.  
If it is moving every two seconds or has stopped, expose the dial to light to charge the watch. "Charging the battery" → P.26

# 2 Pull out the crown to the second click.

The small seconds hand will stop moving.  
\* For models with screw down crown, please unlock the crown before operating it.

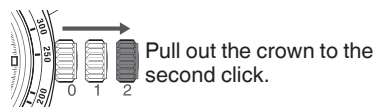

Pull out the crown to the second click.

# 3 Press and hold button A (for 3 seconds) until the stopwatch minute hand starts moving.

The stopwatch minute hand will move and the watch will enter "stopwatch minute hand" preliminary position alignment mode.

\* If you do not know which hand is the stopwatch minute hand, refer to "Names of the parts and their functions" → P.9.

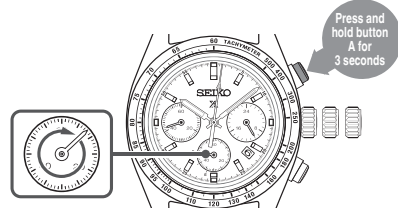

# 4 Press button B to set the stopwatch minute hand to the "34 minute position E".

One minute Advance	Press button once and then release it.
Continuous Advance	When button B is kept pressed for two seconds or longer, the hand will start moving. When button B is released, the hand will stop.

\* When the stopwatch minute hand is set to "34 minute position (E)", continue to procedure 5

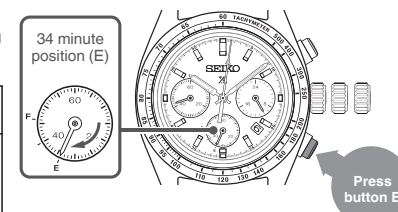

# 5 Press and release button A

The stopwatch 1/5-second hand will move and the watch will enter "stopwatch 1/5-second hand" preliminary position alignment mode.

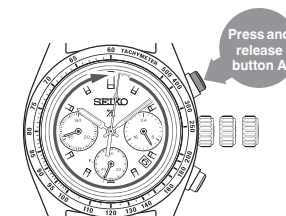

# 6 Press button B to set the stopwatch 1/5-second hand to 0 seconds.

1/5-second Advance	Press button once and then release it.
Continuous Advance	When button B is kept pressed for two seconds or longer, the hand will start moving. When button B is released, the hand will stop.

\* If the stopwatch 1/5-second hand is reset to 0 second, continue to procedure 7

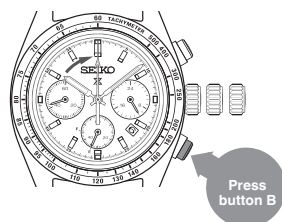

# 7 Push the crown back in to the normal position.

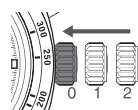

# 8 Set the main time.

"How to set the time and date" → P.13

If the preliminary position adjustment is carried out, the main time may gain or lose time.  
When the main time is set, the operation is completed.

## Troubleshooting

Troubles	Possible causes	Solutions	Reference
The watch stops operating.	The power is completely depleted or low.	Keep charging until the small seconds hand is moving every second.	P.26
The small seconds hand is moving every 2 seconds.	If you wear the watch every day and this occurs, the most likely cause is the watch is hidden by your sleeves or other clothing when you wear it and it is not sufficiently exposed to light.	When you wear the watch, try to make sure that the watch is not hidden by your sleeves or other clothing. Additionally, when you take the watch off, try to place it in a bright place.	
The stopped watch was exposed to an adequate light for longer than "the time required to fully charge the watch", however, it does not resume its normal one-second interval movements or even does not start operating.	The internal watch system is unstable.	See "Resetting the built-in IC" and follow the procedure.	P.58
	The light is too weak. More time is required to fully charge the watch.	The time taken to charge will differ depending on the light intensity. For details on charging times, see "Guide to charging times". If the hands still fail to resume operation, follow the procedure of "Resetting the built-in IC".	P.27 P.58



Troubles	Possible causes	Solutions	Reference
The watch temporarily gains/loses time.	The watch has been left in extremely high or low temperatures for a long time.	If the watch returns to room temperature, the accuracy will return to its original state. If it does not return to its original state, contact the retailer from whom the watch was purchased.	-
	The watch has been left close to an object with a strong magnetic field.	Correct this condition by moving and keeping the watch away from the magnetic source, and reset the time. If this action does not correct the condition, contact the retailer from whom the watch was purchased.	-
	You drop the watch, hit it against a hard surface, or wear it while playing active sports. The watch is exposed to strong vibrations.	If accuracy does not return after setting the time, consult the retailer from whom the watch was purchased.	-
Any of the stopwatch hands do not return to the 0 minute 0 second position when the stopwatch is reset.	Any of the stopwatch hands are out of the preliminary position. This happens when the stopwatch hands are out of the preliminary position as a result of influence of various external sources or after the built-in IC is reset.	Adjust the preliminary position of stopwatch hands.	P.51

## If the hands fail to move or move abnormally even after recharging

When the watch shows an abnormal display or does not properly function, or does not move at all or at one-second intervals even after being fully charged, follow the instructions below to reset the built-in IC. Then the watch will resume its normal operation.

### Resetting the built-in IC

#### 1 Pull out the crown to the second click.

The small seconds hand will stop moving.

\* For models with screw down crown, please unlock the crown before operating it.

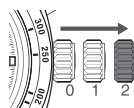

Pull out the crown to the second click.

#### 2 Press and hold buttons A and B simultaneously for three seconds, and release.

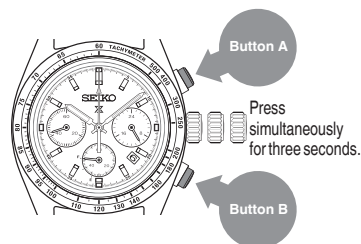

Troubles	Possible causes	Solutions	Reference
The buttons do not work (Nothing happens when they are pressed).	The power is low.	Keep charging until the small seconds hand is moving every second.	P.26
The date changes at 12 o'clock noon.	AM/PM is not properly set.	Advance the hands by 12 hours.	P.13
Blur in the display persists.	A small amount of water has got inside the watch due to deterioration of the gasket, etc.	Consult the retailer from whom the watch was purchased.	-

\* Contact the retailer from whom the watch was purchased for any other troubles.

#### 3 Push the crown back in to the normal position.

The small seconds hand will start moving.

If the small seconds hand is moving every two seconds, keep charging until it is moving every second. → P.26

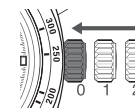

#### 4 Adjust the preliminary position of the stopwatch (1/5-second and minute) hands, and then set the time and date.

- Adjusting the preliminary position of the stopwatch 1/5-second and minute hands → P.51.
- How to set the time and date → P.13

When the preliminary position of the stopwatch hands (1/5-second and minute) are reset, and time and date are correctly set, the operation of resetting the built-in IC is completed.

## Specifications

Cal.	V192
1. Features	3 hands for basic timekeeping (hour, minute and small seconds hand), 24-hour hand, date display, stopwatch hands (1/5-second and minute hand), charge level display.
2. Frequency of crystal oscillator	32,768 Hz (Hz= Hertz, cycles per second)
3. Loss/gain (Monthly rate)	Monthly average loss/gain $\pm$ 15 seconds Only if worn on the wrist in a temperature range of 5°C to 35°C
4. Operational temperature range	-10 °C ~ +60 °C
5. Driving system	Step Motor, 3 pieces
6. Power source	Secondary battery, 1 piece
7. Duration	Approx. 6 months (if the stopwatch is used for 1 hour per day.)
8. IC (Integrated Circuit)	Oscillator, frequency divider and driving circuit C-MOSIC, 1 piece

\* The specifications are subject to change without prior notice due to product improvements.